

# AW DX-RE Cooling/heating fans



# AW DX-RE

## Wall-mounted indoor unit for heat pump – for demanding environments

The AW DX-RE is an advanced development of VEAB's popular AW DX series.

With a robust construction, enhanced corrosion protection and smart, service-friendly design, it delivers efficient heating and cooling where reliability and long lifetime are essential – such as in industrial premises, workshops, warehouses and retail spaces.

- Designed for heating and cooling operation.
- Casing made of Magnelis® ZM310-coated steel sheet, corrosion class C5.
- Heresite-coated coil, corrosion class C5-I & C5-M.
- 4 mm fin spacing reduces maintenance in dusty environments.
- Stainless steel condensate tray with insulation underneath.
- Condensate insulation between coil and casing.
- Adjustable air deflectors for optimized air distribution.
- Service hatch with quick-release fastener.
- Available with AC or EC motor.
- Protection class IP44 for AC motor / IP54 for EC motor.



### Design

The casing is manufactured from galvanised steel with Magnelis coating, providing outstanding resistance to corrosion. The coil consists of copper tubes and aluminium fins coated with Heresite, ensuring a long service life even in aggressive atmospheres. The fan motor is ball-bearing mounted and thermally protected, ensuring quiet and reliable operation. Condensate water is drained via a G½" connection. AW DX-RE is delivered complete with a wall bracket and can be easily connected to outdoor units from various manufacturers.

### Control Unit

The AW DX-RE is controlled via the regulation equipment of the connected outdoor unit.

The model can be combined with outdoor units and control systems from several manufacturers.

### Dimensioning

Dimensioning is easily performed using our web-based calculation software VEAB Air Calc ([www.veab.com](http://www.veab.com)).

### Approvals

The fans are manufactured in accordance with:  
 LVD Directive: EN 60335-1 and EN 60335-2-30  
 EMC Directive: EN 61000-6-2 and EN 61000-6-3  
 EMF Directive: EN 62233



## Specifications

Type		AW DX 22-RE-AC	AW DX 42-RE-AC	AW DX 22-RE-EC	AW DX 42-RE-EC
Coolant		R410A / R32	R410A / R32	R410A / R32	R410A / R32
Max. operating pressure	MPa	4,29	4,29	4,29	4,29
Inner volume coil	liter	2,3	3,7	2,3	3,7
Pipe connection cooling pipe, liquid/gas	tum	3/8" - 5/8"	3/8" - 5/8"	3/8" - 5/8"	3/8" - 5/8"
Condensation drain		G1/2"	G1/2"	G1/2"	G1/2"
Voltage		230 VAC 1ph.	230 VAC 1ph.	230 VAC 1ph.	230 VAC 1ph.
Power consumption	A	0,6	0,95	0,55	1,35
Air volume	m <sup>3</sup> /h	2000	3500	2000	3500
Horizontal range	m	15 <sup>1)</sup> / 8 <sup>2)</sup>	15 <sup>1)</sup> / 8 <sup>2)</sup>	15 <sup>1)</sup> / 8 <sup>2)</sup>	15 <sup>1)</sup> / 8 <sup>2)</sup>
Sound pressure level <sup>3)</sup>	dB(A)	52	62	51	59
Max. ambient temperature	°C	40	40	40	40
Degree of protection		IP44	IP44	IP54	IP54
Weight	kg	48	63	47	62

<sup>1)</sup> Measured at an ambient temperature of 23°C, AW DX unit at a height of 0.7 m, air deflectors angled straight ahead.

<sup>2)</sup> Measured at an ambient temperature of 35°C, AW DX unit at a height of 2.5-3.0 m, air deflectors angled 30° downwards.

<sup>3)</sup> Measured at 5 m in front of AW unit.

## Capacity

Air in °C	Condensation temp °C	AW DX22-RE Heating output kW	AW DX42-RE Heating output kW
15	45	11,1	19,2
20	45	9	15,8

## Accessories

	Product	Description
	Air vents AWLH DX22-RE/DX42-RE	Aluminium deflector blades. Direct air flow sideways.

## Project Design/Orders

### Description - AW DX-RE

Wall-mounted indoor unit for heat pumps, VEAB type AW DX-RE, with a Magnelis ZM310-coated steel casing, corrosion class C5. Heresite-coated heat exchanger with copper tubes and aluminium fins for maximum corrosion resistance. A 4 mm fin spacing reduces maintenance in dusty environments and ensures reliable operation even under demanding conditions. Stainless steel condensate tray with insulation underneath. Condensation insulation between the coil and the casing. Condensate drain with G 1/2" connection. Available with AC or EC motor. Protection class IP44 (AC motor) / IP54 (EC motor). Delivered complete with wall bracket. Adjustable air deflectors available as accessories.

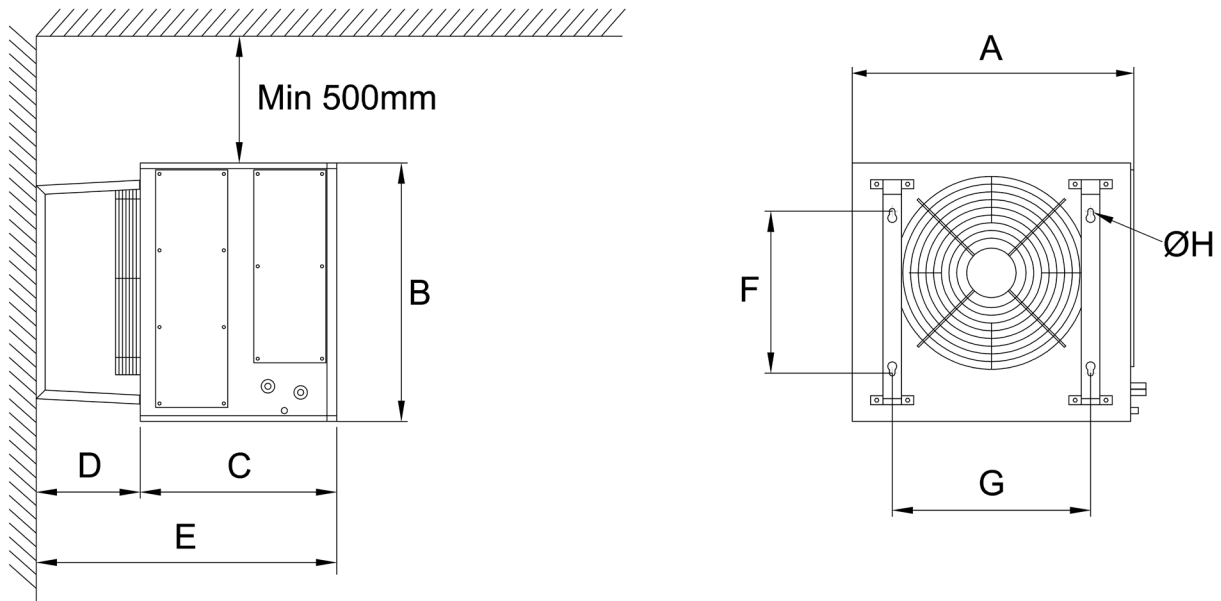

## Dimensional Drawing

Dimensions	A mm	B mm	C mm	D mm	E mm	F mm	G mm	ØH mm
AW DX22RE	740	670	510	270	780	420	515	10
AW DX42RE	920	875	510	270	780	550	700	10



**VEAB Heat Tech AB**  
 Tel +46(0)451-485 00  
[www.veab.com](http://www.veab.com) • [veab@veab.com](mailto:veab@veab.com)  
 Sweden